

'LE LAPEROUSE'

Launching in 2018, exclusively chartered, all-balcony 'Le Laperouse' cruises with commanding grace and style, offering gourmet dining, a marina for Zodiac excursions, a heated infinity pool and an interactive, first-of-its-kind underwater lounge.

Stateroom & Suite Categories

- BUTLER SERVICE INCLUDED
- **Category 8**
Owner's Suite
 - **Category 7**
Grand Deluxe Suite
 - **Category 6**
Prestige Two-Room Suite
 - **Category 5**
Privilege Suite
 - **Category 4**
Deluxe Suite
 - **Category 3**
Prestige Stateroom
 - **Category 2**
Deluxe Stateroom
 - **Category 1**
Classic Stateroom

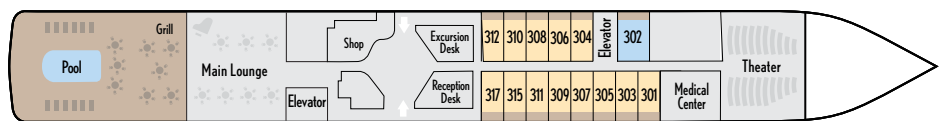
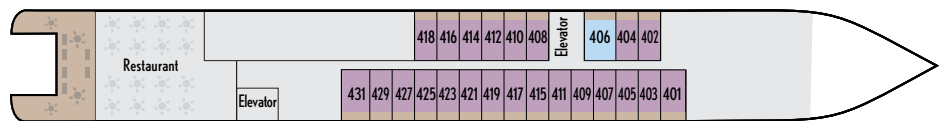
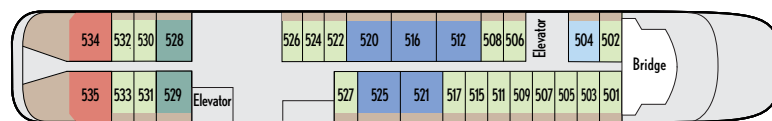
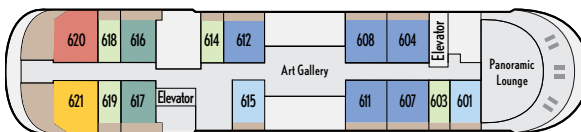
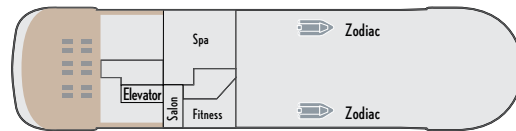

'LE LAPEROUSE' DETAILS

- › Overall length: 430 feet
- › Beam: 59 feet
- › Average speed: 15 knots
- › Passenger decks: 7
- › Passenger capacity: 184, but limited to 150 on A&K charters only
- › Crew and A&K staff: 122 (personnel-to-guest ratio of 1 to 1.25)
- › Standards: Bureau Veritas Clean ship regulations Comfort Class 1 – “Clean” Ship Certification (meets or exceeds all IMO operating standards)
- › Technology: Advanced dynamic positioning system and stabilizers
- › Flag: French

'LE LAPEROUSE' AMENITIES

- › English language on A&K charter
- › Private balcony with every guest stateroom and suite, exclusive to A&K charter
- › Complimentary butler service with Suite categories 4-8, exclusive to A&K charter
- › Sun Deck and multiple outer deck observation areas
- › Marina with mini-port and flotilla of Zodiacs
- › Outside heated infinity pool
- › Theater with seating for up to 188 guests
- › Library with selection of books and games
- › Panoramic restaurant serving French and international cuisine
- › Open bar (excluding premium wines and spirits), an exclusive offering on A&K charters only
- › Three lounges with bars: main lounge; panoramic lounge; and a one-of-a-kind, multi-sensory underwater lounge
- › Complimentary 24-hour room service
- › Complimentary in-cabin breakfast (on request)
- › Three passenger elevators
- › Spa and health center with unique relaxation area, fitness center, massage rooms, salon and *hammam*
- › Boutique shop
- › 24-hour medical facilities with certified doctor
- › Laundry service (no dry cleaning)
- › Electricity: 110/220 volts
- › Wireless Internet, exclusive to A&K charter (access and speed varies)

Stateroom & Suite Layout

Owner's Suite (Category 8)

Cabin: 484 sq. ft. (45 sq. m.)
Balcony: 323 sq. ft. (30 sq. m.)

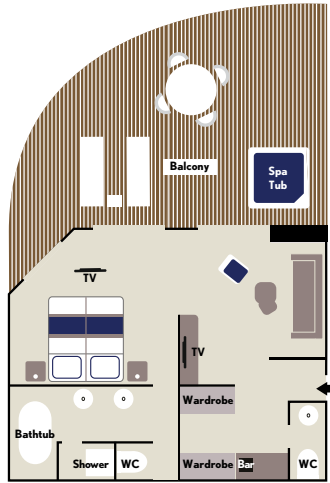

Grand Deluxe Suite (Category 7)

Cabin: 484 sq. ft. (45 sq. m.)
Balcony: 323 sq. ft. (30 sq. m.)

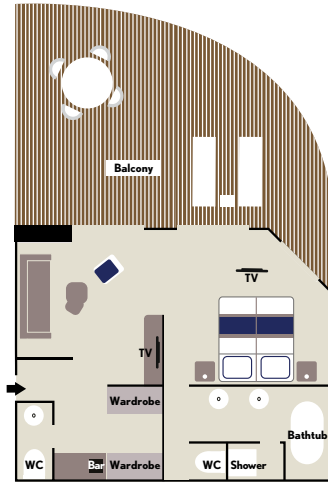

Prestige Two-Room Suite (Category 6)

Cabin: 410 sq. ft. (38 sq. m.)
Balcony: 86 sq. ft. (8 sq. m.)

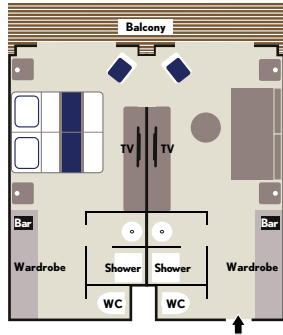

Privilege Suite (Category 5)

Cabin: 344 sq. ft. (32 sq. m.)
Balcony: 86 sq. ft. (8 sq. m.)

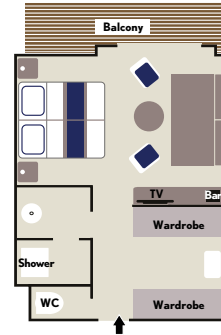

Deluxe Suite (Category 4)

Cabin: 296 sq. ft. (27.5 sq. m.)
Balcony: 65 sq. ft. (6 sq. m.)



Staterooms (Categories 1-3)

Cabin: 205 sq. ft. (19 sq. m.)
Balcony: 43 sq. ft. (4 sq. m.)

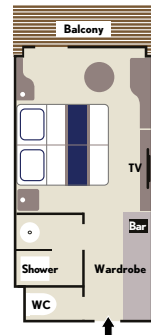

'Le Laperouse' Spa

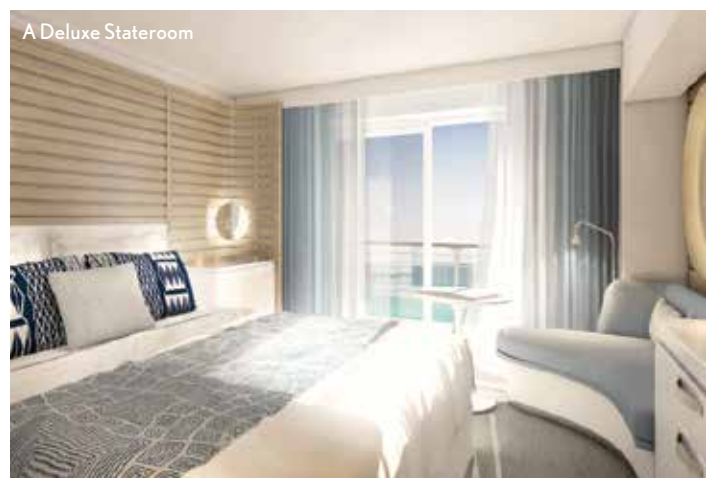

A Deluxe Stateroom



A spacious Prestige Suite

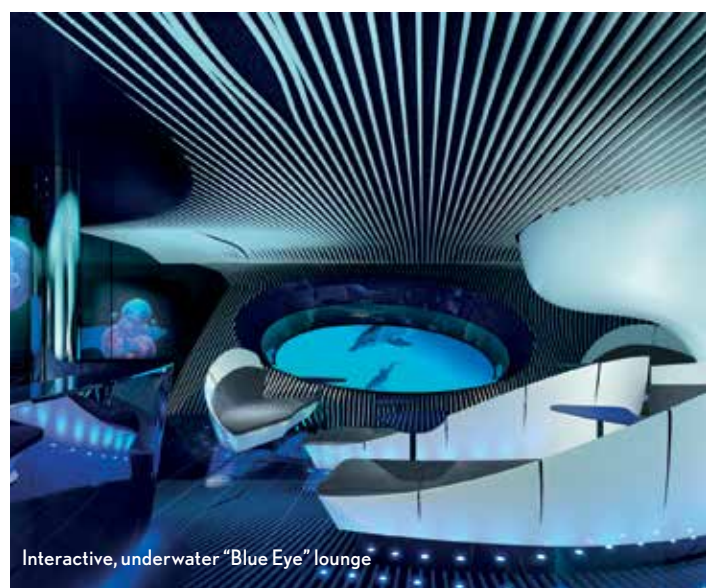

Interactive, underwater "Blue Eye" lounge