

'Le Soleal': Special Configuration for A&K Charters

Exclusively Featured on A&K Expeditions

- ▶ A guest capacity limited to 199 (from a maximum of 264)
- ▶ A&K's acclaimed Expedition Team (average of 20 experts)
- ▶ Intimate personnel-to-guest ratio of 1 to 1.3
- ▶ All English-speaking ship staff
- ▶ Private balcony with every guest stateroom and suite
- ▶ Complimentary butler service with every suite
- ▶ A&K's complimentary Traveller's Valet laundry service
- ▶ Complimentary Wi-Fi (access and speed vary)

Category 1
Classic Stateroom

Category 2
Deluxe Stateroom

Category 3
Premier Stateroom

Category 4
Superior Stateroom

Category 5
Prestige Suite

Category 6
Premier Two-Room Suite
*May be converted to two
Category 3 Staterooms*

Category 7
Prestige Two-Room Suite
*May be converted to two
Category 3 Staterooms*

Category 8
Owner's Suite

BUTLER SERVICE INCLUDED

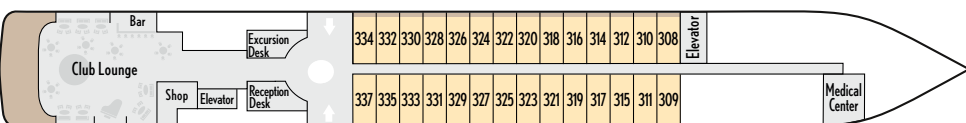
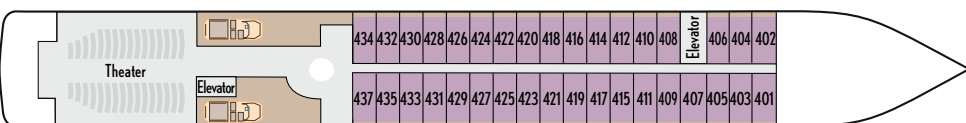
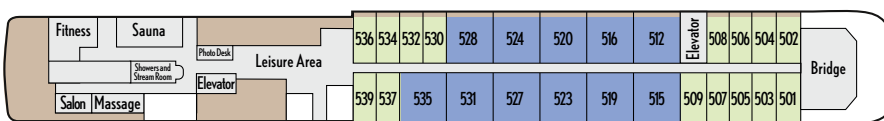
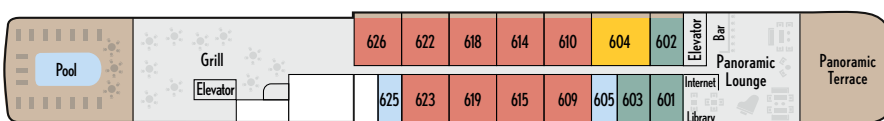
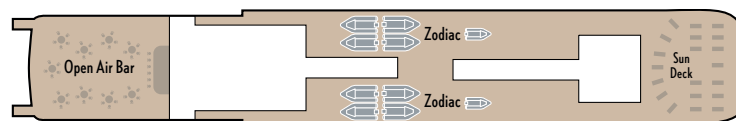

Restaurant located on Deck 2

Amenities

- ▶ Restaurant and Grill featuring indoor/outdoor seating
- ▶ Panoramic Terrace/Bar and Club Lounge/Bar with live music
- ▶ Open bar (excluding premium wines and spirits)
- ▶ Complimentary 24-hour room service
- ▶ Sun Deck and observation areas
- ▶ Heated outdoor pool
- ▶ Full-service Spa with massage rooms, sauna and steam room
- ▶ Panoramic Fitness Center with Kinesis® wall
- ▶ Theater, Library and Boutique
- ▶ Three elevators
- ▶ 24-hour Medical Center with certified doctor and nurse

Ship Details

- ▶ Launched: 2011-2013
- ▶ Overall length: 466 feet
- ▶ Cruising speed: 14 knots
- ▶ Ice class: 1C
- ▶ Technology: Advanced navigation, stabilization, propulsion, and emissions and wastewater management systems
- ▶ Standards: USPHS – U.S. Coast Guard's Rules Comfort Class 1 Clean-Ship Certification (meets or exceeds all IMO, EPA, IAATO and AECO operating standards)
- ▶ Flag: French

All staterooms and suites feature a private balcony, on-demand TV, minibar, Nespresso machine, plush robes and slippers, and luxury bath products.

Every suite includes butler service, welcome Champagne, nightly canapés and packing/unpacking on request.



Categories 1-4
Staterooms
Cabin: 195 sq. ft. (18 sq. m.)
Balcony: 43 sq. ft. (4 sq. m.)

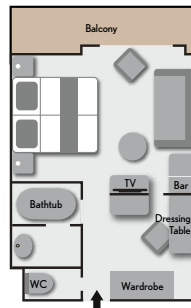

Category 5
Prestige Suite
Cabin: 290 sq. ft. (27 sq. m.)
Balcony: 54 sq. ft. (5 sq. m.)

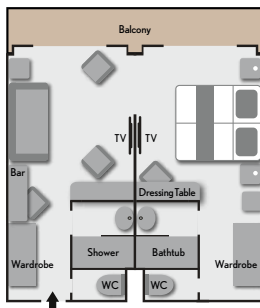

Categories 6-7
Premier and Prestige Two-Room Suites
Cabin: 390 sq. ft. (36 sq. m.)
Balcony: 86 sq. ft. (8 sq. m.)

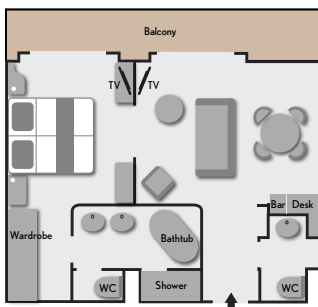

Category 8
Owner's Suite
Cabin: 484 sq. ft. (45 sq. m.)
Balcony: 97 sq. ft. (9 sq. m.)



For detailed pricing and availability, visit abercrombiekent.com.

Prices are per person, double occupancy.