

Luxury Expedition Cruiser: Le Lyrial

Your Exclusively Chartered Vessel Features:

- ▶ A guest capacity limited to 199 (from a maximum of 244)
- ▶ A&K's acclaimed Expedition Team (average of 20 experts)
- ▶ Intimate personnel-to-guest ratio of 1 to 1.3
- ▶ All English-speaking ship staff
- ▶ Private balcony with every guest stateroom and suite
- ▶ Complimentary butler service with every suite
- ▶ A&K's complimentary Traveller's Valet laundry service
- ▶ Complimentary Wi-Fi (access and speed vary)

- Category 1**
Classic Stateroom
- Category 2**
Deluxe Stateroom
- Category 3**
Premier Stateroom
- Category 4**
Prestige Suite
- Category 5**
Premier Two-Room Suite
May be converted to two Category 3 Staterooms
- Category 6**
Privilege Two-Room Suite
- Category 7**
Grand Deluxe Two-Room Suite
- Category 8**
Grand Privilege Three-Room Suite
- Category 9**
Owner's Suite
- BUTLER SERVICE INCLUDED**

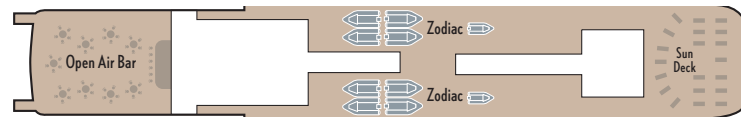

DECK 7

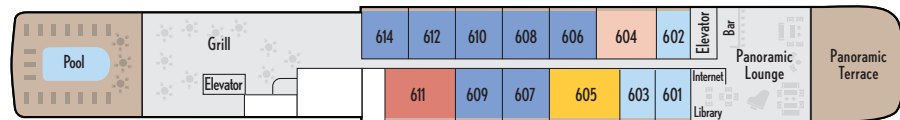

DECK 6

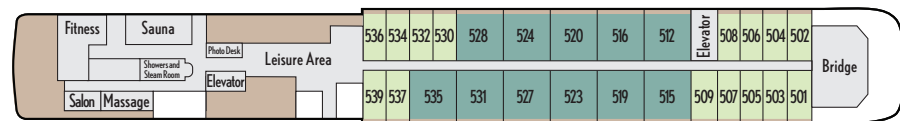

DECK 5

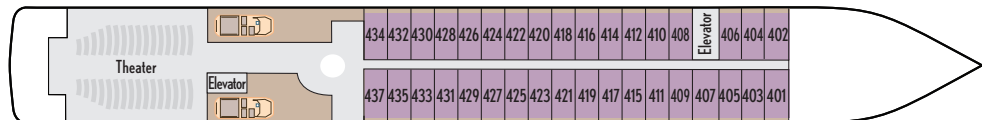

DECK 4

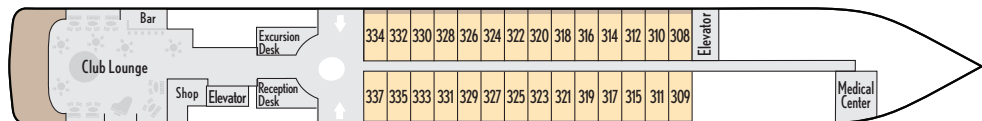

DECK 3

Restaurant located on Deck 2

Amenities:

- ▶ Restaurant and Grill featuring indoor/outdoor seating
- ▶ Panoramic Terrace/Bar and Club Lounge/Bar with live music
- ▶ Open bar (excluding premium wines and spirits)
- ▶ Complimentary 24-hour room service
- ▶ Sun Deck and observation areas
- ▶ Heated outdoor pool
- ▶ Full-service Spa with massage rooms, sauna and steam room
- ▶ Panoramic Fitness Center with Kinesis® wall
- ▶ Theater, Library and Boutique
- ▶ Three elevators
- ▶ 24-hour Medical Center with certified doctor and nurse

Ship Details:

- ▶ Launched: 2015
- ▶ Overall length: 466 feet
- ▶ Cruising speed: 14 knots
- ▶ Ice class: 1C
- ▶ Technology: Advanced navigation, stabilization, propulsion, and emissions and wastewater management systems
- ▶ Standards: USPHS – U.S. Coast Guard's Rules Comfort Class 1 Clean-Ship Certification (meets or exceeds all IMO, EPA, IAATO and AECO operating standards)
- ▶ Flag: French

All staterooms and suites feature a private balcony, on-demand TV, minibar, Nespresso machine, plush robes and slippers, and luxury bath products.

Every suite includes butler service, welcome Champagne, nightly canapés and packing/unpacking on request.

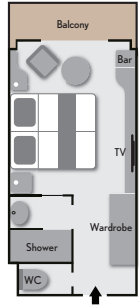

Categories 1-3
Staterooms
Cabin: 195 sq. ft. (18 sq. m.)
Balcony: 43 sq. ft. (4 sq. m.)

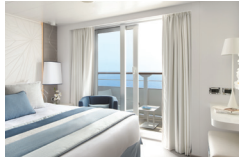

Category 4
Prestige Suite
Cabin: 291 sq. ft. (27 sq. m.)
Balcony: 65 sq. ft. (6 sq. m.)

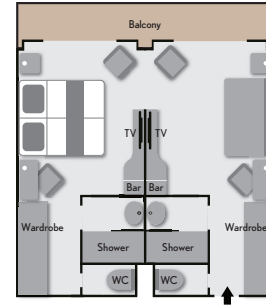

Category 5
Premier Two-Room Suite
Cabin: 390 sq. ft. (36 sq. m.)
Balcony: 86 sq. ft. (8 sq. m.)

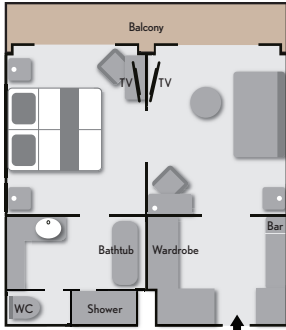

Category 6
Privilege Two-Room Suite
Cabin: 390 sq. ft. (36 sq. m.)
Balcony: 86 sq. ft. (8 sq. m.)

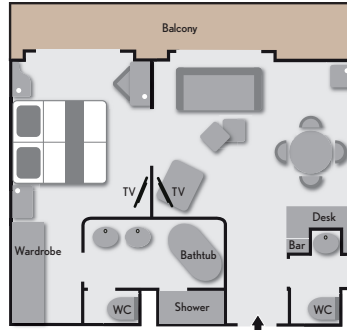

Category 7
Grand Deluxe Two-Room Suite
Cabin: 484 sq. ft. (45 sq. m.)
Balcony: 108 sq. ft. (10 sq. m.)

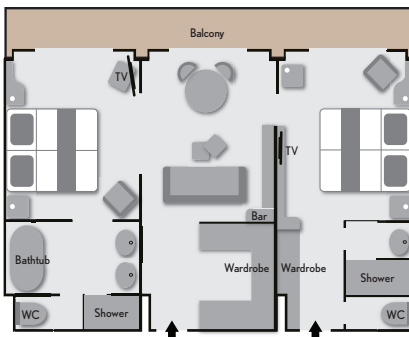

Category 8
Grand Privilege Three-Room Suite
Cabin: 581 sq. ft. (54 sq. m.)
Balcony: 129 sq. ft. (12 sq. m.)

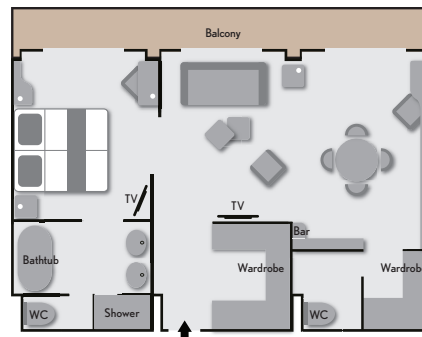

Category 9
Owner's Suite
Cabin: 581 sq. ft. (54 sq. m.)
Balcony: 129 sq. ft. (12 sq. m.)



Sail Le Lyrial on These A&K Luxury Expedition Cruises

Arctic Cruise Adventure: In Search of the Polar Bear | Antarctica, South Georgia & Falklands: Holiday Voyage
Antarctica, South Georgia & Falklands Expedition